

# L'ECUREUIL

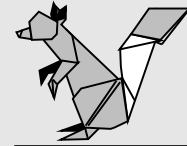

Modèle et Diagramme :  
Christophe Boudias ;-)

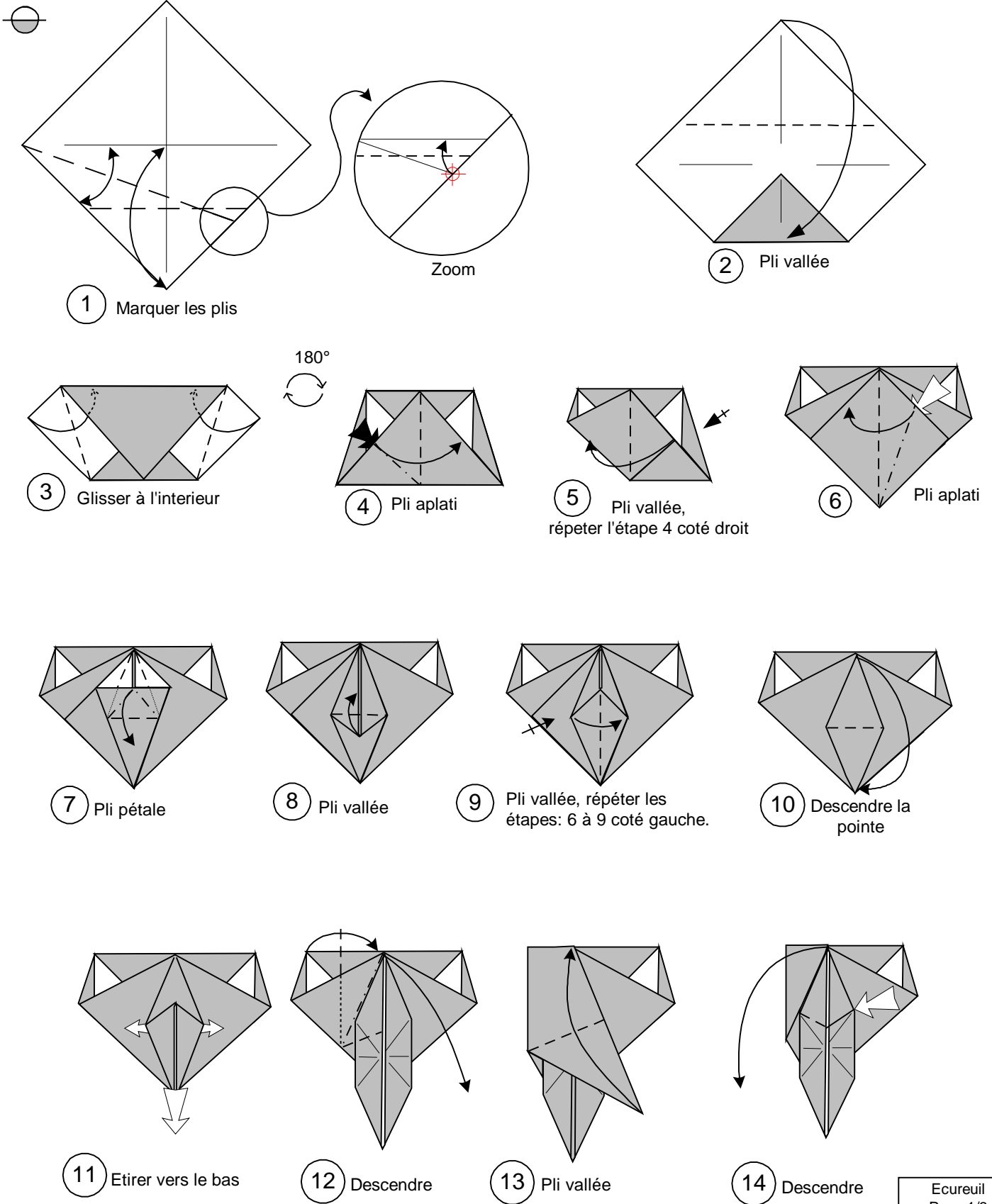

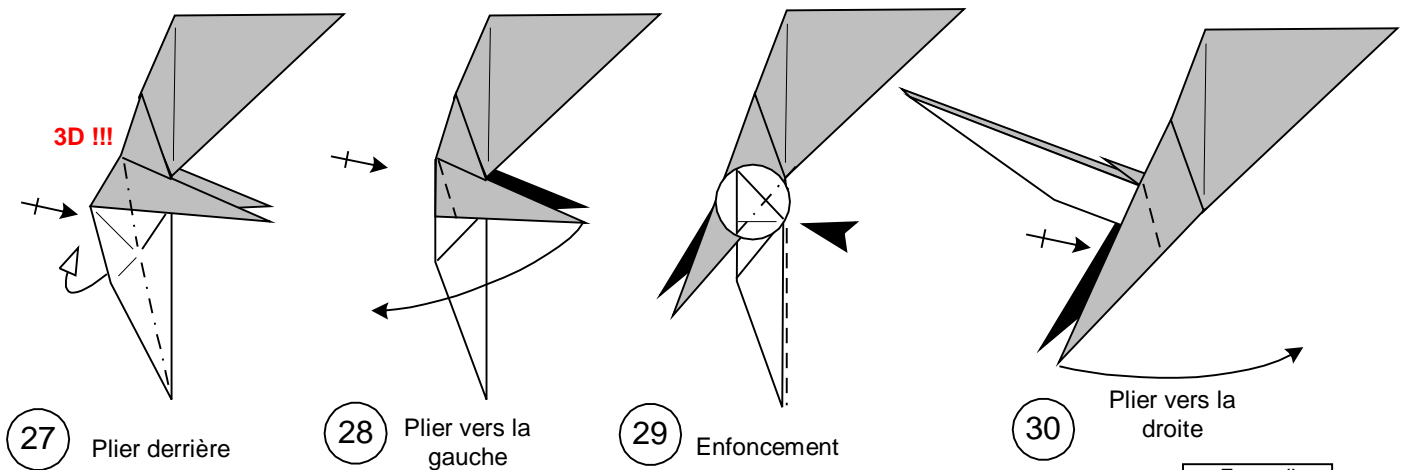
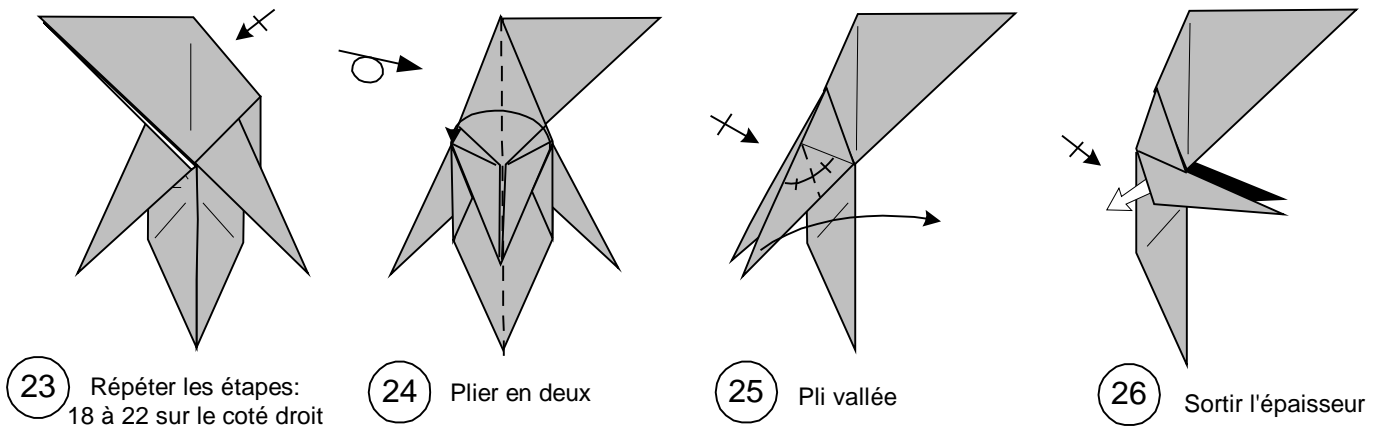
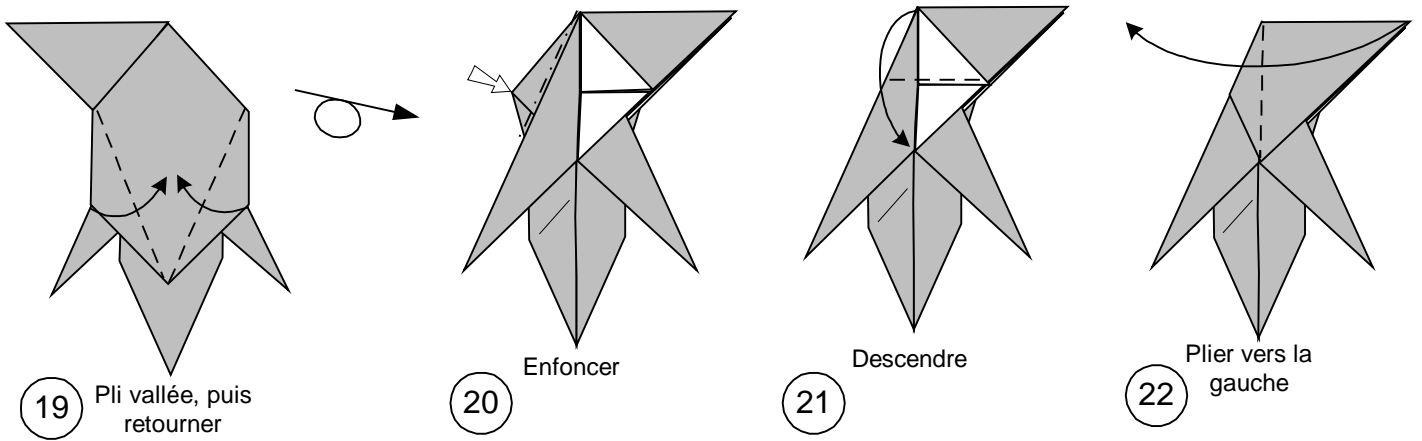
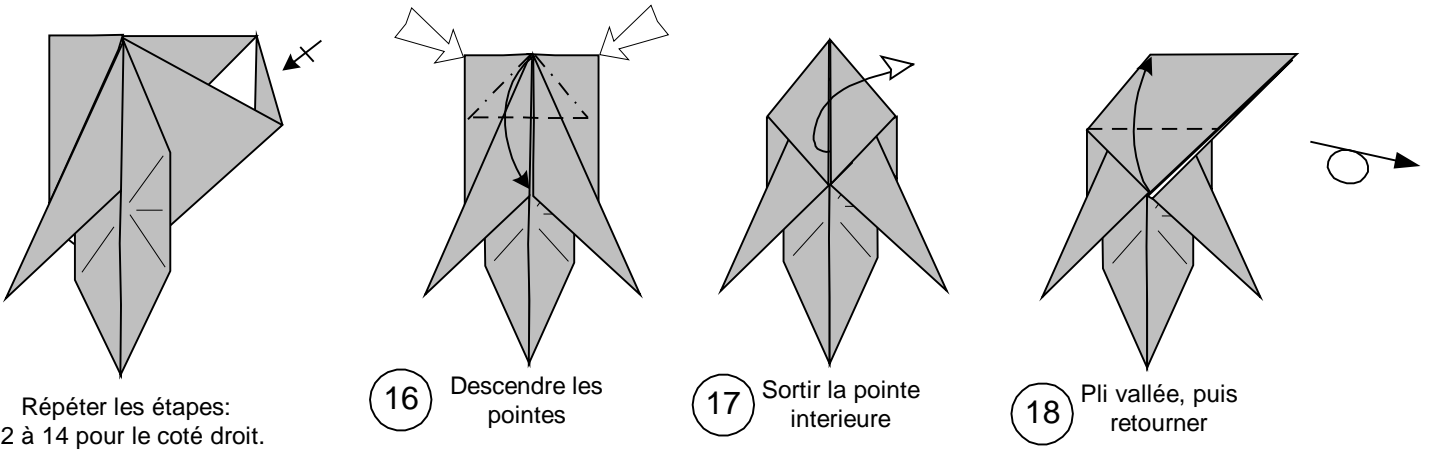

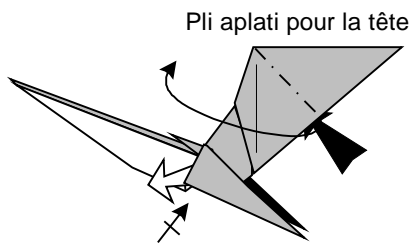

31 sortir l'épaisseur pour la queue.

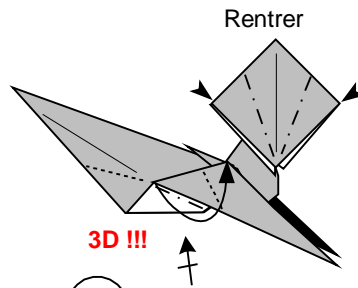

32

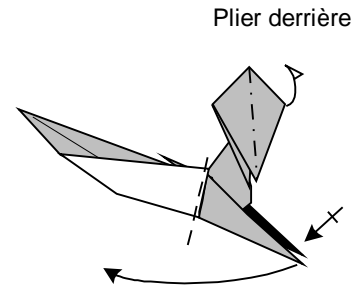

33 Plier vers la gauche

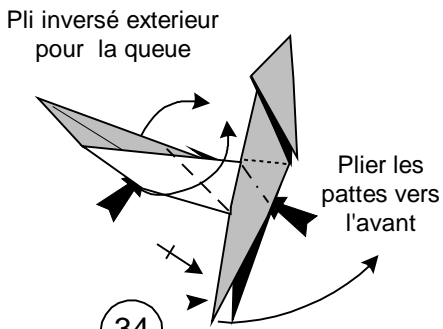

34

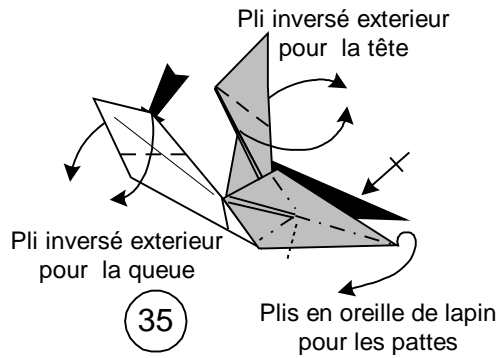

35

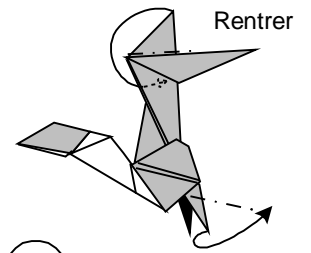

36 Former les pattes

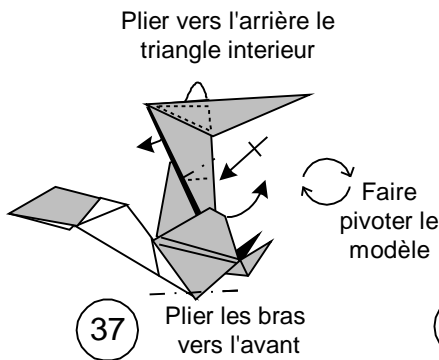

37 Plier les bras vers l'avant

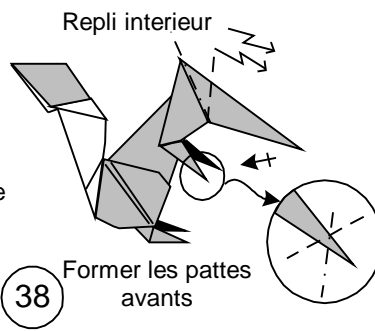

38 Former les pattes avants

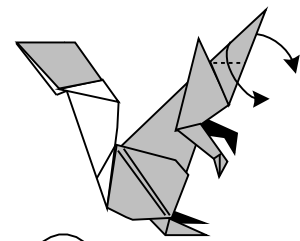

39 Pli inversé extérieur pour former la tête

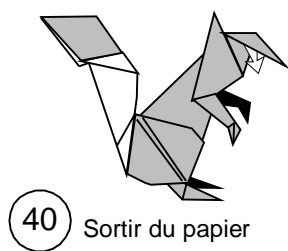

40 Sortir du papier

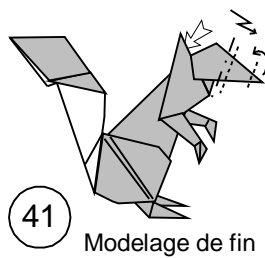

41 Modelage de fin

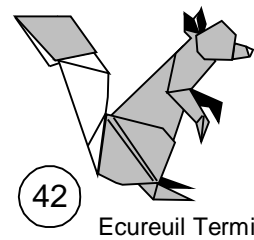

42 Ecureuil Terminé !!!

